

A D V A N T A G E

Introducing the New Combo Nut Washers

Features

- Available in 1/4"-20, 3/8"-16 & 1/2"-13.
- Easily installs with one hand.
- Combination design reduces the number of parts to handle.
- Serrated flange negates the need for a flat washer.
- Allows for easy adjustment when installed in channel.
- Provides quick attachment for threaded rod.
- Reduces installation time.
- *Also available in 316 stainless steel - add SS6 to part number.*



Catalog #	Thread Size	Torque ft-lbs	Pull-Out Load (lbs) in channel			Slip Load (lbs) in channel		
			12 ga.	14 ga.	16 ga.	12 ga.	14 ga.	16 ga.
NW524	1/4"-20	6	450	450	450	300	300	300
NW528	3/8"-16	19	1000	1000	1000	800	600	600
NW525	1/2"-13	25	1500	1400	1000	1000	700	700

Loads have a safety factor of 3.

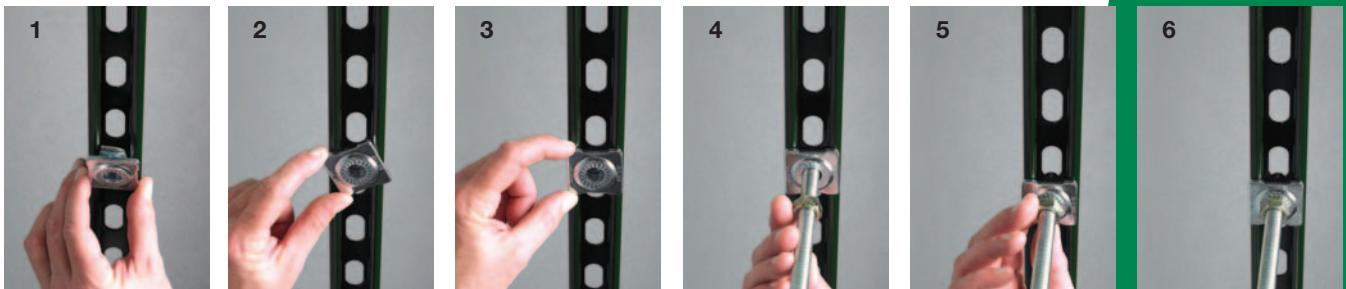

1. Position combo nut in channel.
2. Rotate clockwise as nut seats in channel.
3. 90° rotation has combo nut locked in channel.
4. Slide combo nut into the desired location in the channel and insert threaded rod into nut.
5. Thread the rod up through the nut and lock into place with hex nut.
6. Rod is ready for support products to be installed.

Patent Pending

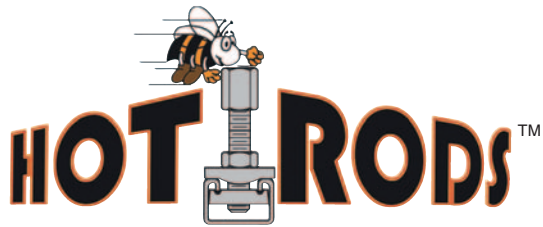

The fastest solution when installing all threaded rods to strut trapeze/supports and adding multiple-tier trapezes.

Features

- 12" lengths of all threaded rod completely assembled with rod coupling and locking hex nut on one end and a channel nut, square washer and locking hex nut on the other end: Ready to Install! No separate parts and pieces.
- Hot Rods™ allow for speeding installation of all channel trapeze supports - "pre-fabrication" of trapezes just got easier!
- With the pre-assembled Hot Rods™, simply attach to the pre-cut channel supports/trapezes and connect to the desired ATR lengths for a completed trapeze support in seconds. Completely adjustable for setting elevations.



Hot Rods™ are available in 1/4", 3/8", 1/2", and 5/8" rod diameters. All parts are electro zinc plated.

Catalog #	UPC/Part #	Rod Size	Std. Pkg.
BHR1225ZN **	78205134564	1/4"-20	20
BHR1238ZN **	78205134565	3/8"-16	20
BHR1250ZN **	78205134566	1/2"-13	20
BHR1262ZN	78205134567	5/8"-11	20

** These sizes use the combo nut washer shown on front of sheet.

